



INSTRUCTION BULLETIN

No. 3723
Machine: 5700
Published: 6-95/00
System: SCRUBBING

NOTE: DO NOT DISCARD the Parts List from the Instruction Bulletin. Place the Parts List in the appropriate place in your machine manual for future reference. Retaining the Parts List will make it easier to reorder individual parts and will save you the cost of ordering an entire kit.

NOTE: Numbers in parenthesis () are reference numbers for parts listed in Bill of Materials.

Installation Instructions for Kit number 222812

SYNOPSIS / PROBLEM:

This kit contains the parts needed to replace the solution tank filter screen/power wand screen on the machine listed above. The solution screen may fall out of position in the present configuration. This kit will eliminate the problem by providing a more positive location for the screen. Please follow step-by-step instructions.

SPECIAL TOOLS / CONSIDERATIONS: Hand drill, 1/2 in. drill bit

(Estimated Time to complete: 1 hour)

INSTALLATION OF SOLUTION LINE SCREEN:

(Refer to FIG. 1)

FOR SAFETY: Before leaving or servicing machine, stop on level surface and set parking brake. Then turn off machine and remove key.

1. Drain the solution tank.
2. Raise the solution tank and engage safety arm.
3. Reach inside the tank and remove the old solution line screen from the left front corner of the tank. (Refer to Fig. 1)
4. Go under the solution tank and loosen the worm drive clamp holding the pinch valve hose to the tank nipple. Pull the pinch valve hose off the tank nipple. (Refer to Fig. 1)
5. Remove the two hex screws holding the water valve mounting bracket to the tank. Let the valve drop down, out of the way. (Refer to Fig. 1)
6. Use the hand drill and 1/2 in. drill bit in the hole in the tank nipple. Drill the hole out to the 1/2 in. dimension. (Refer to Fig. 1)
7. Position the plastic fitting (2) in the solution line hole from the bottom up. (Refer to Fig. 1)
8. Position the pinch valve hose back on the tank nipple. Reinstall the worm drive clamp and tighten. (Refer to Fig. 1)
9. Reinstall the water valve mounting bracket to the bottom of the tank. (Refer to Fig. 1)
10. Reach inside the solution tank and position the new screen (1) on the fitting (2) that was just installed. (Refer to Fig. 1)

11. Disengage the safety arm, lower the solution tank, fill with water and check for leaks.

NOTE: The short hose (3) provided in this kit is not used when installing a new screen on the solution line.

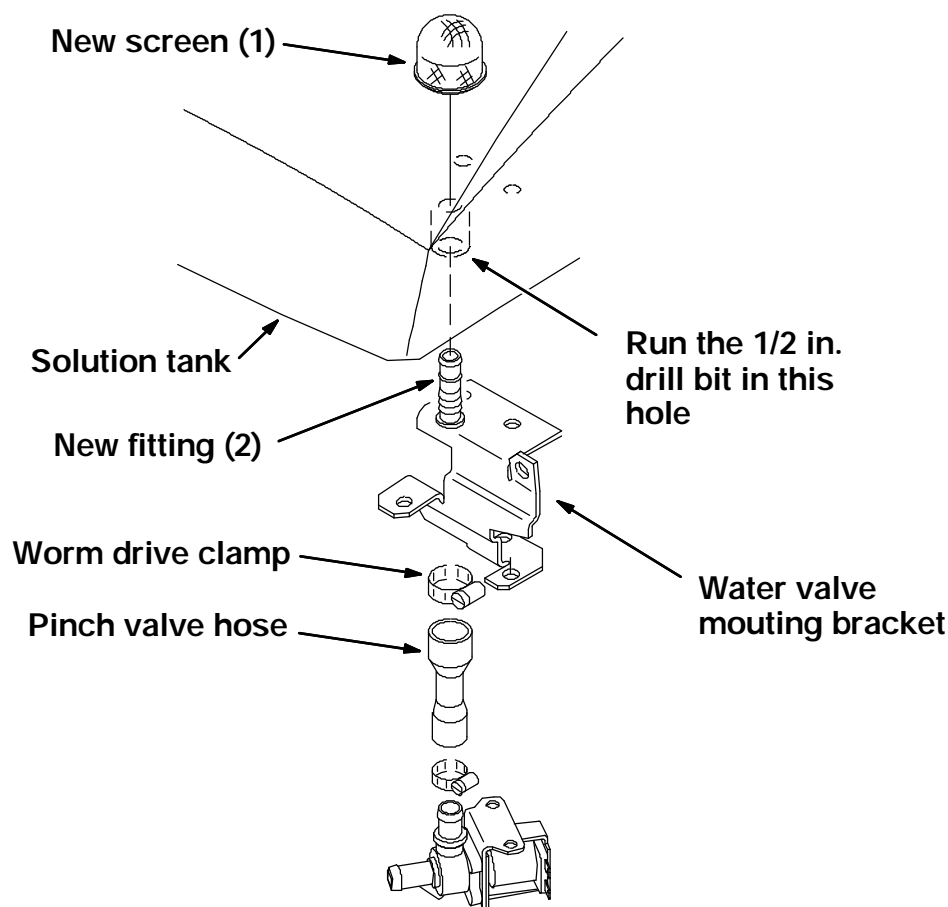

FIG. 1 - Solution Line Screen

INSTALLATION OF POWER WAND SCREEN:

(Refer to FIG. 2)

FOR SAFETY: Before leaving or servicing machine, stop on level surface and set parking brake. Then turn off machine and remove key.

1. Drain the solution tank.
2. Raise the solution tank and engage safety arm.
3. Reach inside the tank and remove the old power wand screen from the right front corner of the tank. (Refer to Fig. 2)
4. Go under the solution tank and loosen the worm drive clamp holding the hose to the outlet of the power wand pump. Pull the hose off the pump. (Refer to Fig. 2)
5. Disconnect the power wand pump from the electrical harness. (Refer to Fig. 2)
6. Remove the power wand pump from the bottom of the solution tank. This is done by turning the pump counter-clockwise. (Refer to Fig. 2)
7. Position the short hose (3) on the plastic fitting (2). (Refer to Fig. 2)
8. Position the plastic fitting (2) and short hose (3) in the power wand pump hole from the bottom up. (Refer to Fig. 2)

9. Reinstall the power wand pump. Turn clockwise until it is tight. (Refer to Fig. 2)
10. Reconnect the power wand pump to the main electrical harness. (Refer to Fig. 2)
11. Reconnect the hose to the outlet of the power wand pump. Tighten the worm drive clamp. (Refer to Fig. 2)
12. Reach inside the solution tank and position the new screen (1) on the fitting (2) that was just installed. (Refer to Fig. 2)

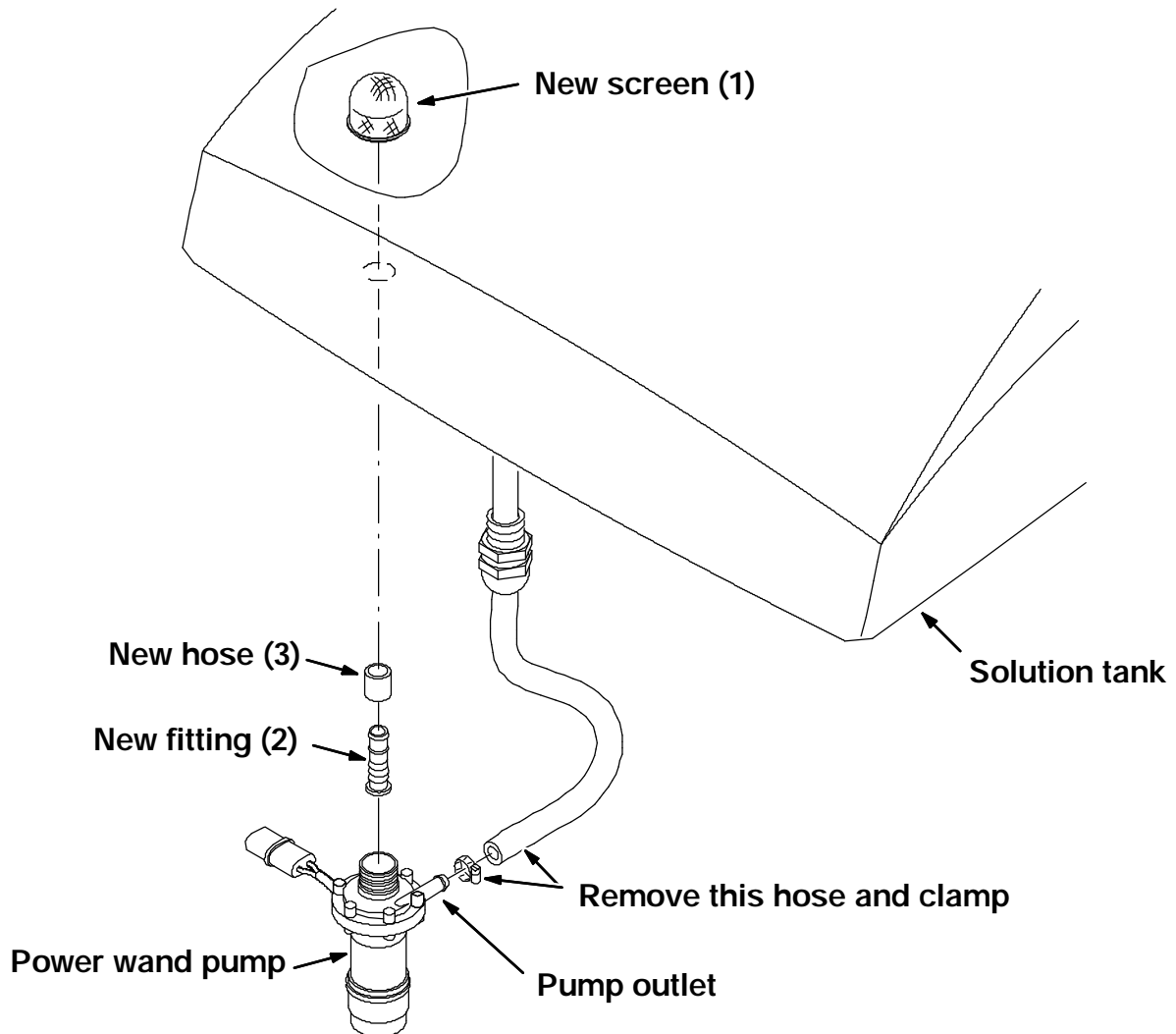

FIG. 2 - Power Wand Pump Screen

BILL OF MATERIALS FOR SCREEN REPLACEMENT KIT 222812

Ref.	TENNANT Part No.	Description	Qty.
1	222742	Screen	1
2	222728	Fitting	1
3	222750	Hose	1

TENNANT COMPANY
P. O. Box 1452
Minneapolis, MN 55440-1452